



CRAFTSMAN ELEVATION

The Somerset

1061 Kingston Cres.

1694 Sq.Ft.

Two-Storey

Sunshine Basement

9' Main Floor Ceilings

Hardwood Flooring

Tile Flooring

Granite Countertops

Natural Gas Fireplace to Great Room

Undermount Sinks

Vaulted Ceiling in Master Bedroom

7'x9' Rear Deck

\$334,035

Includes home, land & gst

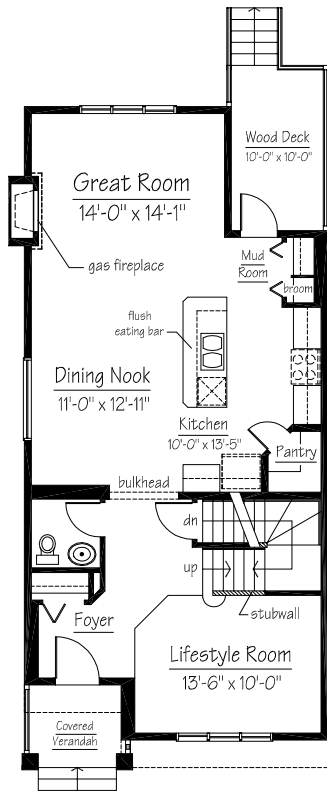

MAIN FLOOR PLAN

921 sq. ft.

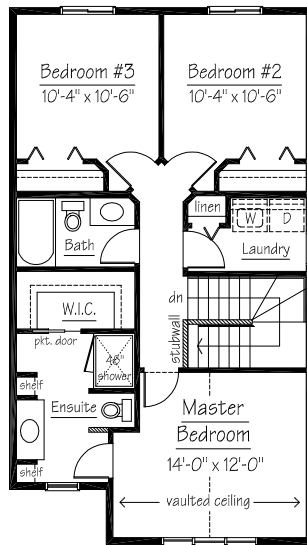

UPPER FLOOR PLAN

773 sq. ft.

King's  Heights

Showhome Hours:

Monday - Thursdays 2-8 pm

Saturday, Sundays & Holidays

noon - 5 pm

Contact

Lynn Abrams @ 403-510-0357 or

Chris Herriman @ 403-542-5545

for information on this home or other models available for quick possession.

reidbuilthomes.com

REIDBUILT HOMES
MASTER BUILDER

Due to ongoing improvements resulting from continuing research and development programs, we reserve the right to alter design or specifications without notice or obligation. All illustrations are the artists concepts. This plan is the property of Reid Built Homes Ltd. All rights reserved.