

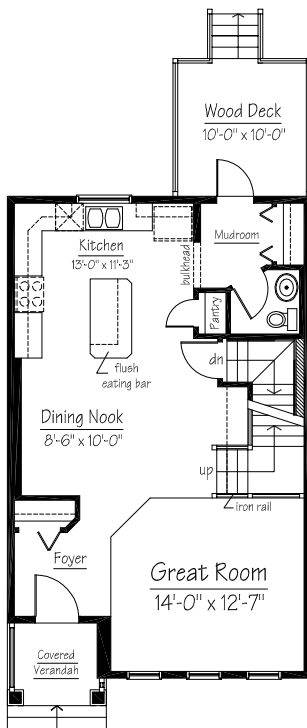

GEORGIAN ELEVATION



MAIN FLOOR PLAN

744 sq. ft.

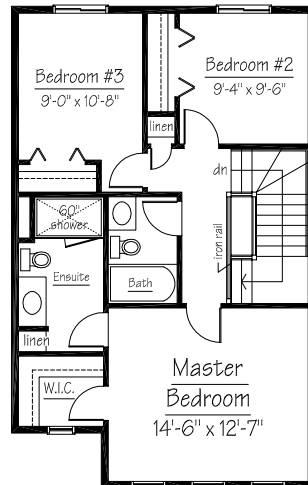

UPPER FLOOR PLAN

681 sq. ft.

The Oxford

1029 Kingston Cres.

1425 Sq.Ft.

Two-Storey

9' Main Floor Ceilings

Hardwood Flooring

Tile Flooring

Granite Countertops

Undermount Sinks

3-Piece Rough-In

Wrought Iron Railing

10'x10' Rear Deck

\$311,283

Includes home, land & gst

King's  Heights

Showhome Hours:

Monday - Thursdays 2-8 pm

Saturday, Sundays & Holidays

noon - 5 pm

Contact

Lynn Abrams @ 403-510-0357 or

Chris Herriman @ 403-542-5545

for information on this home or other models available for quick possession.

reidbuilt homes.com

REIDBUILT HOMES
MASTER BUILDER

Due to ongoing improvements resulting from continuing research and development programs, we reserve the right to alter design or specifications without notice or obligation. All illustrations are the artists concepts. This plan is the property of Reid Built Homes Ltd. All rights reserved.